

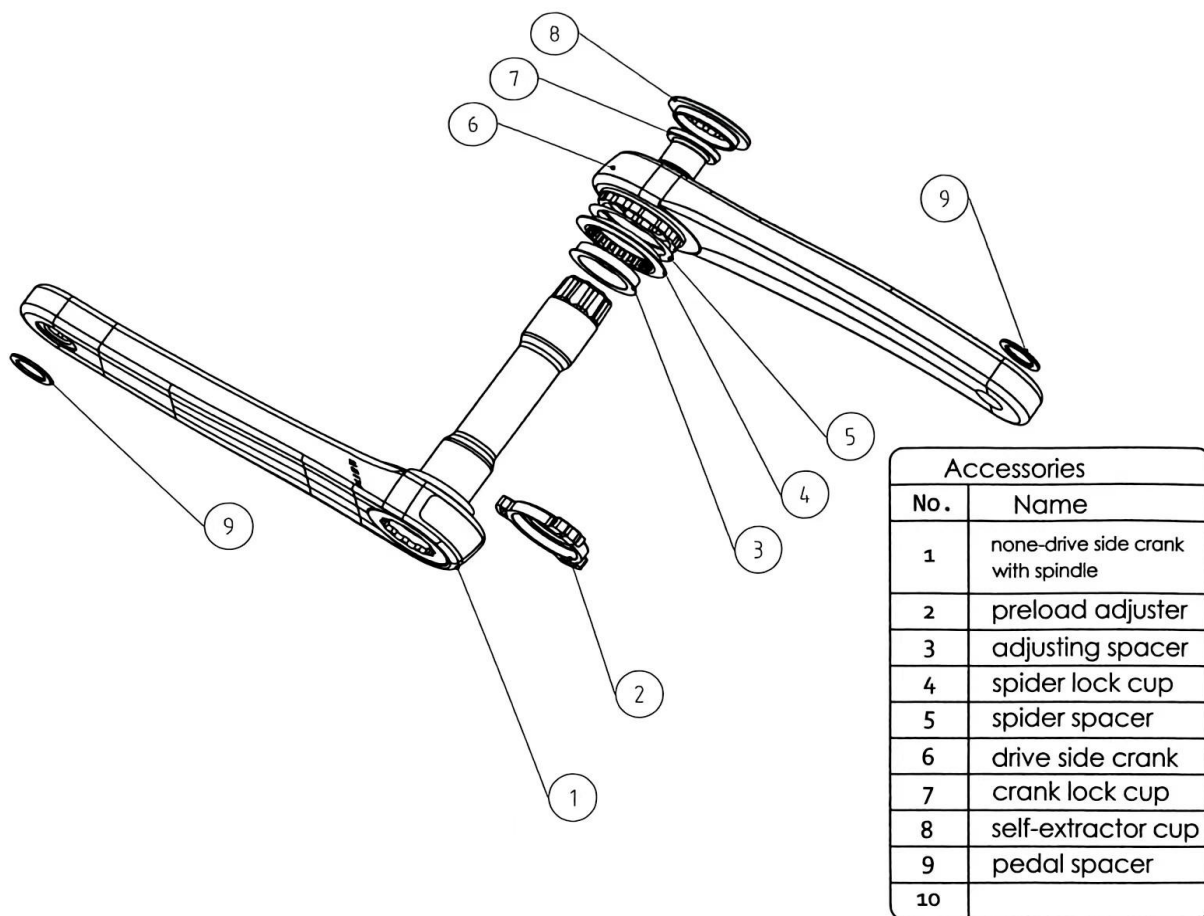

www.elilee.com



24mm Crank Manual

Step 1. Take the cranks and the accessories out of the box, use BBT22 spline bottom bracket tool to tighten ① spider lock cup to fix the spider (power meter) on the ⑥ drive side crank, then install the chainring.

Step 2. Insert the crank set through the bottom bracket, use the ③ adjusting spacers to fill the gap between bottom bracket and the cranks. But make sure to leave a gap of 0.5mm-3mm for step 4.

Step 3. Use torque wrench to tighten ⑦ crank lock cup at 40Nm, to fix ① none-drive side crank with spindle and ⑥ drive side crank.

Step 4. Tighten the screw on ② preload adjuster until there's no gap between bottom bracket and the cranks. (② preload adjuster has to be used for smooth rotation)

Compatibility

Measure the length of the bottom bracket after it has been installed on the bike, the length should be less than 91.5mm.

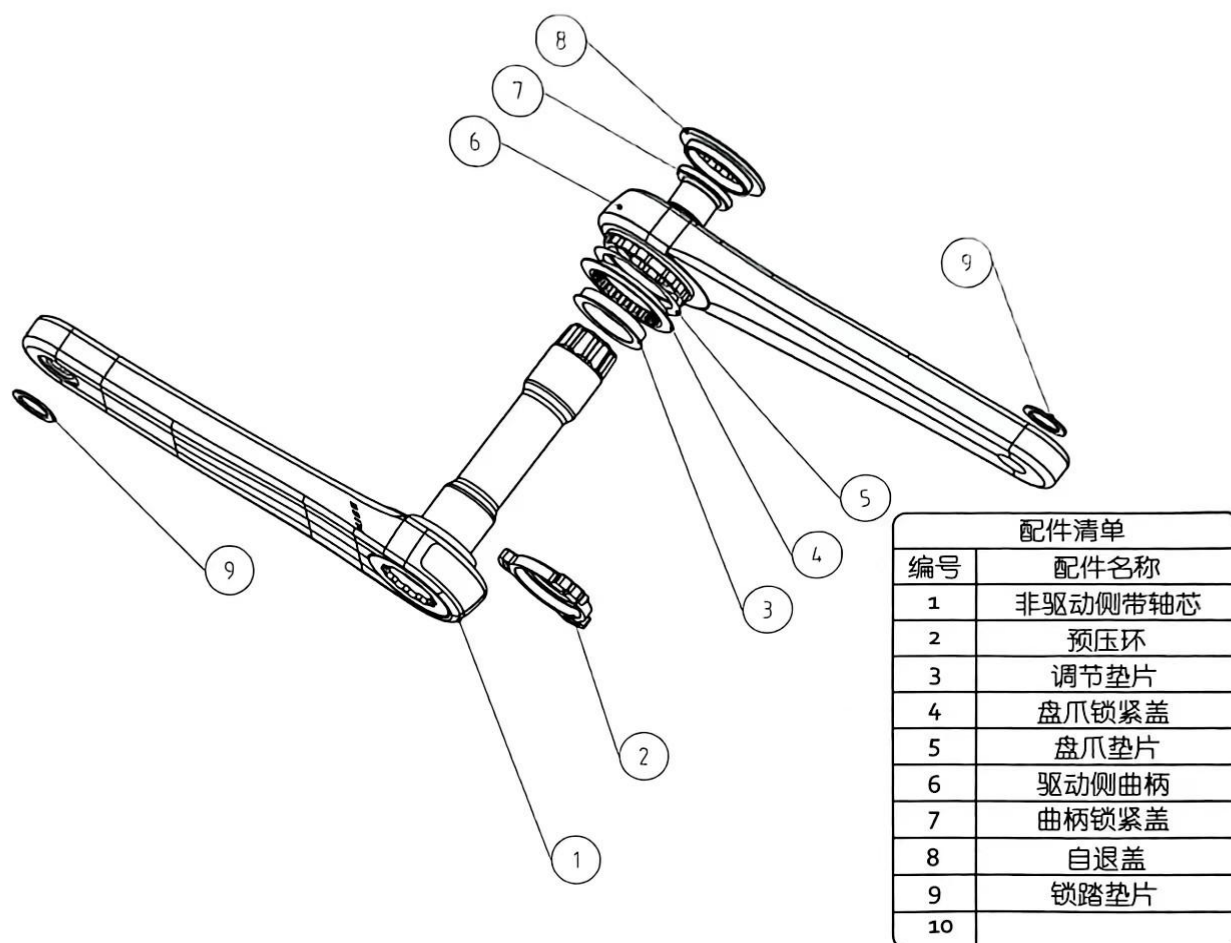

24mm轴心安装说明

第1步：将曲柄与配件从盒中取出，安装盘爪（功率计），使用BBT22花键中轴安装工具锁紧④盘爪锁紧盖，将盘爪（功率计）固定在⑥驱动侧曲柄上，随后安装好盘片。

第2步：将曲柄插入中轴，根据自身需求添加③调节垫片消除中轴和曲柄间的间隙，但需至少保留0.5mm-3mm，以便在第4步用②预压环调节。

第3步：使用扭矩扳手，设置为40Nm，锁紧⑦曲柄锁紧盖以固定①非驱动侧带轴心和⑥驱动侧曲柄。

第4步：调节②预压环上的螺丝，直到中轴和曲柄间没有空隙。（为保证转动顺畅预压环必须使用）

兼容性

请测量中轴安装到车架上后的长度，此长度应低于91.5mm。



www.elilee.com

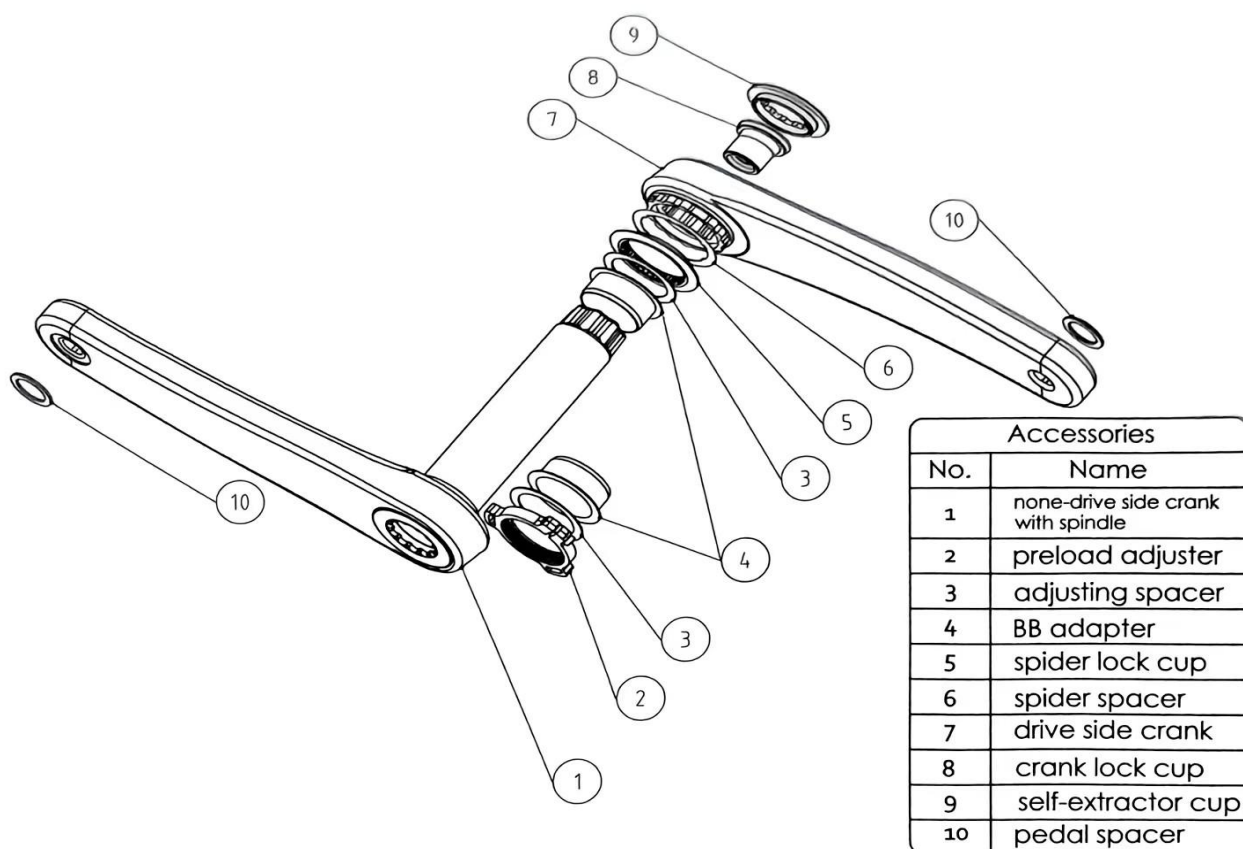

28mm Crank Manual

Step 1. Take the cranks and the accessories out of the box, use BBT22 spline bottom bracket tool to tighten ⑤ spider lock cup to fix the spider (power meter) on the ⑦ drive side crank, then install the chainring.

Step 2. Set ④ BB adapters (dub/30mm) on the bottom bracket, then insert the crank set through the bottom bracket, use the ③ adjusting spacers to fill the gap between bottom bracket and the cranks. But make sure to leave a gap of 0.5mm-3mm for step 4.

Step 3. Use torque wrench to tighten ⑥ crank lock cup at 40Nm, to fix ① none-drive side crank with spindle and ⑦ drive side crank.

Step 4. Tighten the screw on ② preload adjuster until there's no gap between bottom bracket and the cranks. (② preload adjuster has to be used for smooth rotation)

Compatibility

Measure the length of the bottom bracket after it has been installed on the bike, the length should be less than 91.5mm.

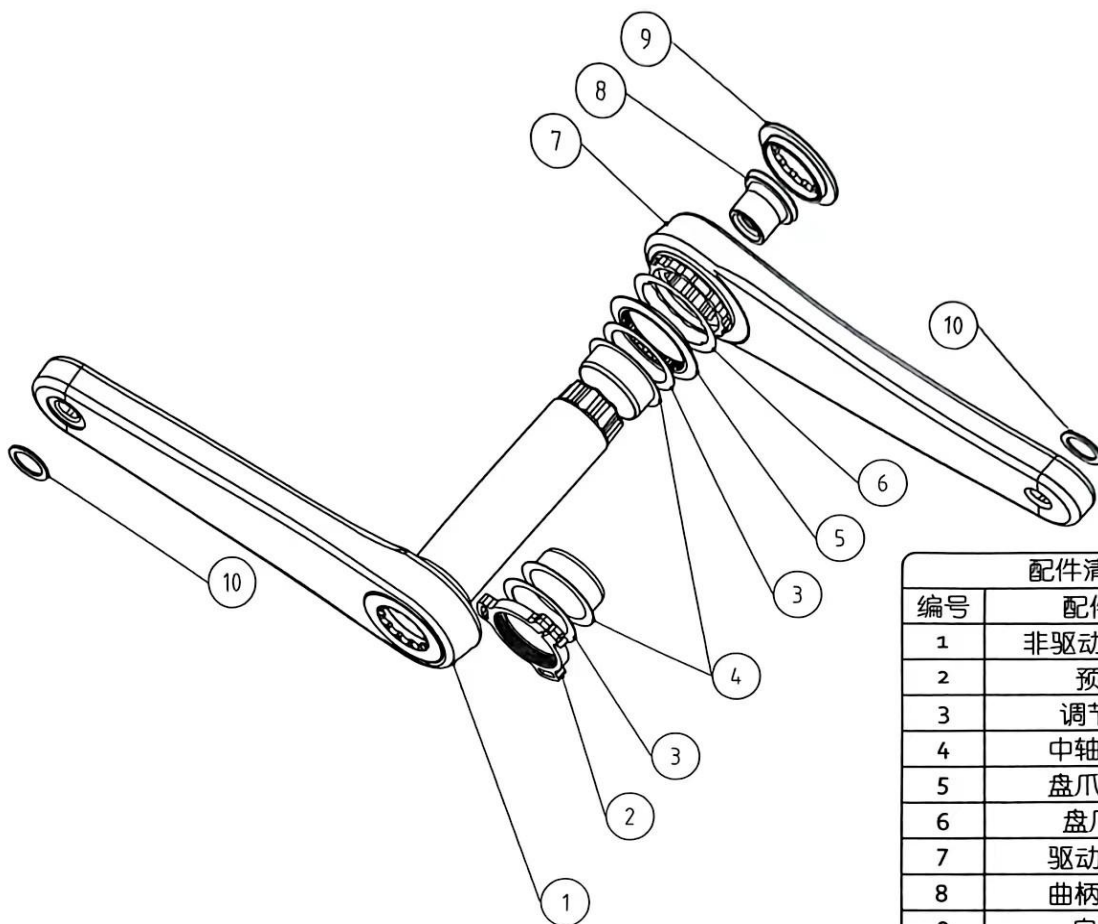

配件清单	
编号	配件名称
1	非驱动侧带轴芯
2	预压环
3	调节垫片
4	中轴变径套
5	盘爪锁紧盖
6	盘爪垫片
7	驱动侧曲柄
8	曲柄锁紧盖
9	自退盖
10	锁踏垫片

28mm轴芯安装说明

第1步：将曲柄与配件从盒中取出，安装盘爪（功率计），使用BBT22花键中轴安装工具锁紧⑤盘爪锁紧盖，将盘爪（功率计）固定在⑦驱动侧曲柄上，随后安装好盘片。

第2步：将④中轴变径套（dub或30mm）安装在中轴上，随后将曲柄插入中轴，根据自身需求添加③调节垫片消除中轴和曲柄间的间隙，但需至少保留0.5mm-3mm，以便在第4步用②预压环调节。

第3步：使用扭矩扳手，设置为40Nm，锁紧⑧曲柄锁紧盖以固定①非驱动侧带轴芯和⑦驱动侧曲柄。

第4步：调节②预压环上的螺丝，直到中轴和曲柄间没有空隙。（为保证转动顺畅预压环必须使用）

兼容性

请测量中轴安装到车架上后的长度，此长度应低于91.5mm。